

Naugatuck Public Schools

# Paving & Site Work Upgrades

497 Rubber Ave.  
Naugatuck, Connecticut 06770

- Andrew Avenue Elementary School
- City Hill Middle School

PROJECT LOCATION MAP

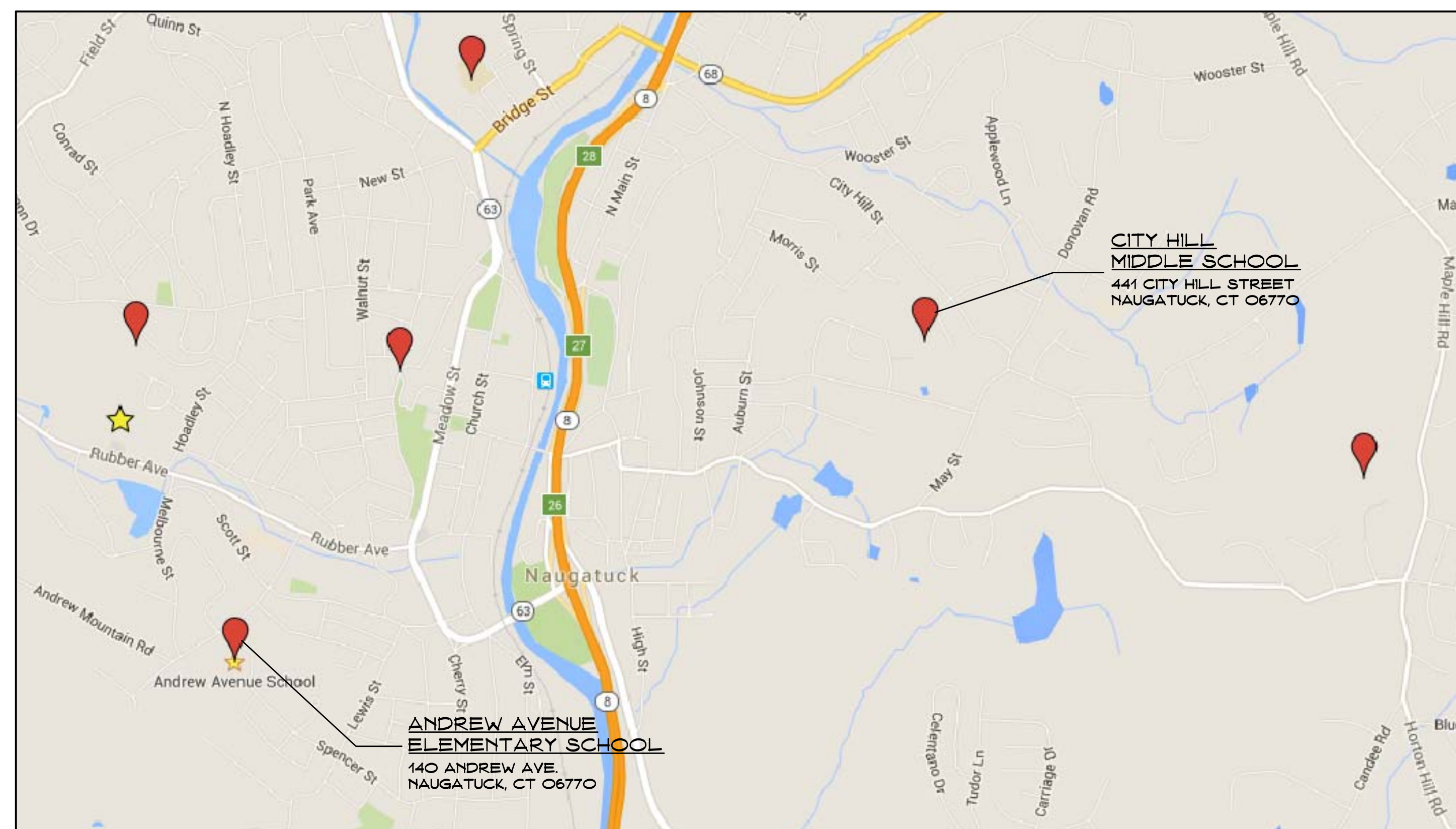

LIST OF DRAWINGS

<u>SITE</u>	
CS	COVER SHEET
CS100	LAYOUT, MATERIALS & MARKING PLANS AND NOTES
CS101	DETAILS



SILVER / PETRUCCELLI + ASSOCIATES

*Architects / Engineers / Interior Designers*

3190 Whitney Avenue, Hamden, CT 06518-2340  
Tel. 203 230 9007 Fax. 203 230 8247  
[silverpetrucci.com](http://silverpetrucci.com)

July 14, 2017

ISSUED FOR BID

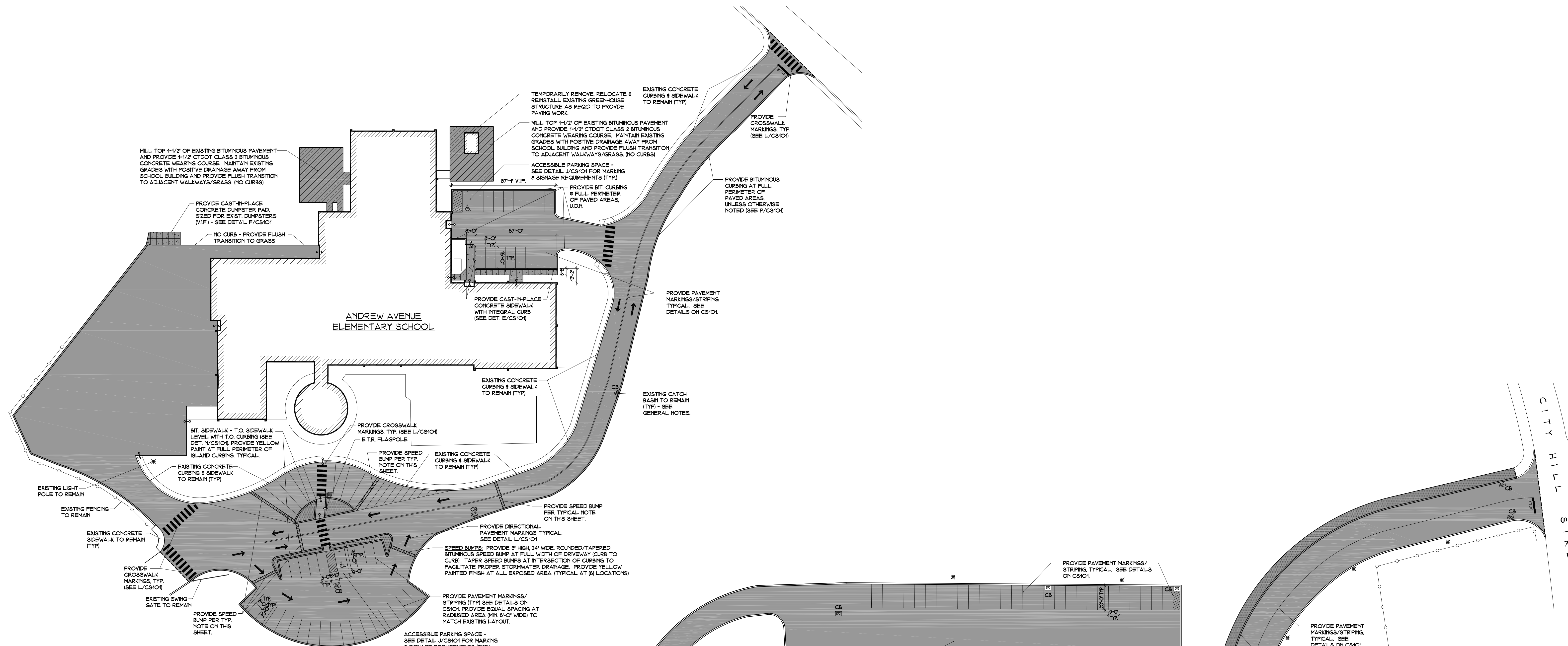

**ANDREW AVENUE ELEMENTARY SCHOOL  
LAYOUT, MATERIALS & MARKING PLAN**  
SCALE: 1" = 40'-0"  
CS-100A

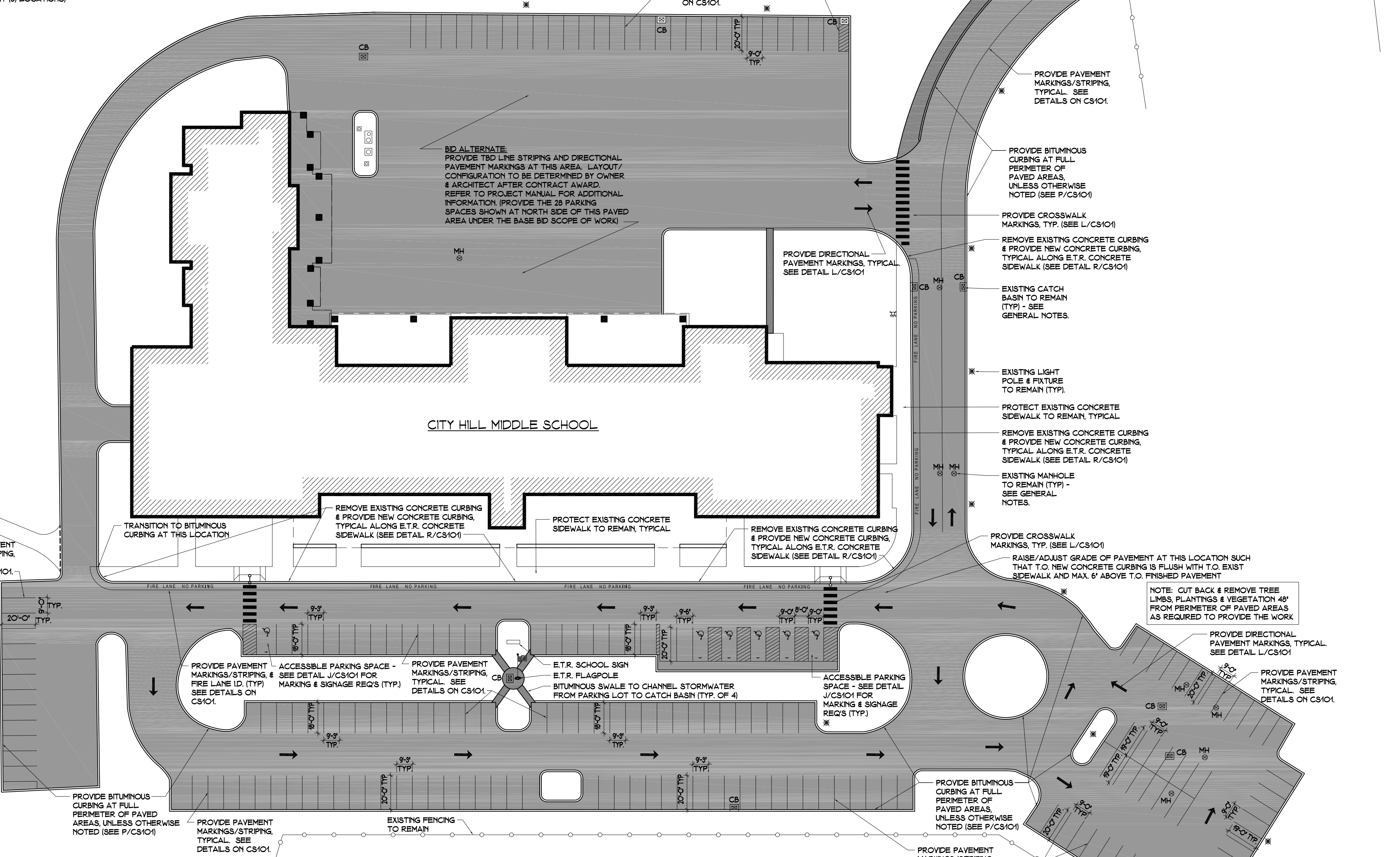

**CITY HILL MIDDLE SCHOOL  
LAYOUT, MATERIALS & MARKING PLAN**  
SCALE: 1" = 40'-0"  
CS-100B

SYMBOL LEGEND	
	EXISTING ELEMENT TO REMAIN
	WORK LIMIT BOUNDARY - SAWCUT JOINT BETWEEN PAVEMENT TO BE REMOVED & E.T.R. PAVEMENT
	PAVEMENT BOUNDARY W/O OUT CURBING
	PAVEMENT BOUNDARY WITH CURBING (PROVIDE CURBING)
	EXISTING BITUMINOUS PAVEMENT TO BE REMOVED & REPLACED
	EXISTING BITUMINOUS SIDEWALK TO BE REMOVED & REPLACED
	EXISTING CONCRETE WALK/CURB TO BE REMOVED & REPLACED
	DETECTABLE WARNING
	ET.R. CATCH BASIN (SEE GENERAL NOTES)
	ET.R. MANHOLE (SEE GENERAL NOTES)
	FLUSH CONDITION
	FENCING (EXIST. TO REMAIN)

**GENERAL NOTES**

- CONTRACTOR IS RESPONSIBLE FOR CONTACTING 'CALL BEFORE YOU DIG' LOCATING SERVICE AT 1-800-922-4665 AT LEAST SEVENTY-TWO (72) HOURS PRIOR TO THE START OF DEMOLITION AS REQUIRED TO HAVE ALL UTILITIES LOCATED AND MARKED BEFORE WORK BEGINS. CONTRACTOR IS ALSO RESPONSIBLE FOR ENGAGING SERVICES OF INDEPENDENT UTILITY LOCATING SERVICE TO LOCATE UNDERGROUND UTILITIES NOT COVERED BY CBD.
- CONTRACTOR IS RESPONSIBLE FOR REPAIRING OR REPLACING ANY UTILITIES DAMAGED DURING CONSTRUCTION.
- SYMBOLS AND LEGENDS OF PROJECT FEATURES ARE GRAPHIC REPRESENTATIONS AND ARE NOT NECESSARILY SHOWN ON THE DRAWINGS TO SCALE OR TO THEIR ACTUAL DIMENSIONS OR LOCATION. COORDINATE DETAIL SHEET DIMENSIONS, MANUFACTURER'S LITERATURE, SHOP DRAWINGS AND FIELD MEASUREMENTS OF SUPPLIED PRODUCTS FOR LAYOUT OF THE PROJECT FEATURES.
- DO NOT RELY SOLELY ON ELECTRONIC VERSIONS OF DRAWINGS, SPECIFICATIONS AND DATA FILES THAT ARE PROVIDED BY THE ARCHITECT. FIELD VERIFY LOCATION OF PROJECT FEATURES AND NOTIFY ARCHITECT IMMEDIATELY IF DISCREPANCIES ARE FOUND.
- PERFORM NECESSARY CONSTRUCTION NOTIFICATIONS, APPLY FOR AND OBTAIN NECESSARY PERMITS, PAY FEES, AND POST BONDS ASSOCIATED WITH THE WORK AS REQUIRED BY THE CONTRACT DOCUMENTS.
- THE CONTRACTOR IS RESPONSIBLE FOR PROTECTING AND MAINTAINING UTILITIES WITHIN THE PROJECT AREA OF WORK.
- ALL EXISTING MANHOLE RIMS, CATCH BASIN GRATES, VALVE COVERS AND OTHER SIMILAR STRUCTURES SHALL BE RESET WITH FINAL GRADES. REPLACE ANY DAMAGED RIMS, TOPS, GRADES AND VALVE COVERS.
- PROVIDE ADA SIDEWALK RAMPS AT ALL TRANSITIONS BETWEEN SIDEWALKS AND PAVED DRIVEWAY/PARKING AREAS. SEE DETAIL K/C/S101.

- WORK RESTRICTIONS:**
- DO NOT CLOSE OR OBSTRUCT ROADWAYS, SIDEWALKS, FIRE HYDRANTS OR UTILITIES WITHOUT APPROPRIATE PERMITS AND AUTHORIZATION FROM NAUGATUCK PUBLIC SCHOOLS & A.H.U.
  - WORK IS RESTRICTED TO THE HOURS OF LOCAL BUSINESS OPERATIONS PER THE BOROUGH OF NAUGATUCK.
  - HOURS OF WORK SHALL BE COORDINATED WITH NAUGATUCK PUBLIC SCHOOLS AT EACH WORK LOCATION INCLUDING SCHOOL STAFF (PRINCIPAL & CUSTODIAN) AND DISTRICT FACILITIES MANAGER.

- REGULATORY REQUIREMENTS:**
- WITHIN LOCAL RIGHTS-OF-WAY PERFORM THE WORK IN ACCORDANCE WITH LOCAL MUNICIPAL STANDARDS.
  - WITHIN STATE RIGHTS-OF-WAY PERFORM THE WORK IN ACCORDANCE WITH THE LATEST EDITION OF THE DEPARTMENT OF TRANSPORTATION'S STANDARD SPECIFICATIONS AND ISSUED REVISIONS/SUPPLEMENTS.
  - PROVIDE TRAFFIC SIGNAGE AND PAVEMENT MARKINGS IN CONFORMANCE WITH THE LATEST EDITION OF THE MANUAL OF UNIFORM TRAFFIC CONTROL DEVICES.
  - CONTRACTOR IS RESPONSIBLE FOR SITE SECURITY AND JOBSITE SAFETY. PERFORM CONSTRUCTION ACTIVITIES IN ACCORDANCE WITH OSHA STANDARDS AND LOCAL REQUIREMENTS.
  - CONTRACTOR IS RESPONSIBLE FOR PROVIDING SUITABLE BARRIERS AROUND THE AREA OF WORK TO RESTRICT PUBLIC AND OTHERWISE UNAUTHORIZED ACCESS TO THE JOBSITE.

- CONSTRUCTION LAYOUT:**
- PROVIDE PROPER TRANSITIONS BETWEEN EXISTING AND PROPOSED SITE IMPROVEMENTS. FIELD VERIFY EXISTING PAVEMENT AND ELEVATIONS AT THE INTERFACE WITH PROPOSED PAVEMENTS AND DRAINAGE STRUCTURES BEFORE START OF CONSTRUCTION.

- PAVEMENT:**
- AT A MINIMUM, CONSTRUCT ACCESSIBLE ROUTES, PARKING SPACES, RAMPS, SIDEWALKS AND WALKWAYS IN CONFORMANCE WITH THE FEDERAL AMERICANS WITH DISABILITIES ACT AND WITH STATE AND LOCAL LAWS AND REGULATIONS (MOST STRINGENT REQUIREMENTS GOVERN).
  - AT AREAS OF DAMAGED WEAR & BINDER COURSE, REMOVE 2" OF WEAR & BINDER COURSE DOWN TO BASE MATERIAL AROUND PERIMETER OF DAMAGED AREA. REPAIR & COMPACT BASE MATERIAL AND PROVIDE FULL BINDER & WEAR COURSE.
  - PAVEMENT GRADES FOR NEW AND RESURFACED AREAS SHALL BE ADJUSTED/GRADED TO PITCH WATER TO EXISTING CATCH BASINS TO ELIMINATE PONDING.

**GRADING NOTES**

- UNLESS NOTED OTHERWISE MEET LINE AND GRADE TO PROVIDE A SMOOTH TRANSITION AT ALL INTERFACES OF NEW AND EXISTING CURBS AND PAVEMENTS.
- ACCESSIBLE ROUTES' SLOPES SHALL BE 120 (5%) OR LESS AND THE CROSS SLOPES SHALL NOT BE GREATER THAN 1/2 INCH AND SLOPES SHALL NOT BE GREATER THAN 120 UNLESS RAMPS OR LIFTS ARE PROVIDED.
- UNLESS NOTED OTHERWISE, CONCRETE PADS AT DOORS SHALL BE FITTED AT 2X AWAY FROM BUILDING.
- THE SLOPE OF ALL ACCESSIBLE PARKING SPACES SHALL NOT EXCEED 2X IN ANY DIRECTION.
- UNLESS SHOWN OTHERWISE, CROSS-PITCH ALL WALKS LOCATED ALONG CURBS AT 2X TOWARDS THE CURB.
- CARE IS TO BE TAKEN WHEN PAVING TO PROPERLY GRADE THE PARKING AREAS AND DRIVEWAYS IN ORDER TO AVOID PONDING AND PROVIDE PROPER DRAINAGE.
- UNLESS NOTED OTHERWISE CONTRACTOR SHALL ADJUST FRAME TOPS FOR ALL UTILITY AND DRAINAGE STRUCTURES TO MEET NEW GRADES OF RECLAIMED AND REPAVED SURFACES.
- PROVIDE ADEQUATE COMPACTION OF FILL AT AREAS WHERE FILL IS REQUIRED.
- ADEQUATELY STABILIZE ALL DISTURBED SLOPES.

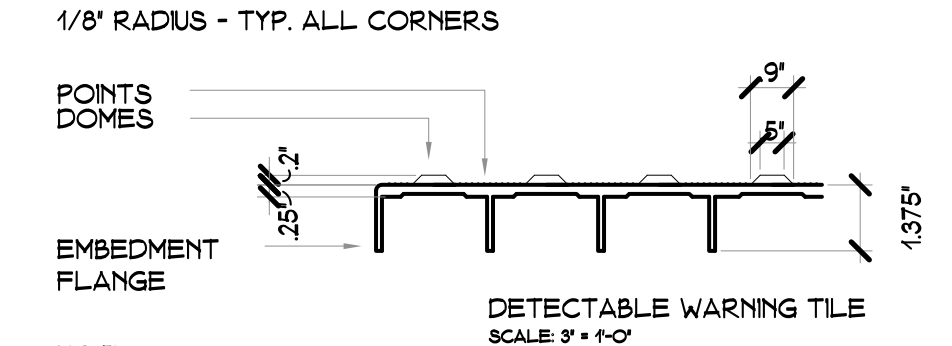
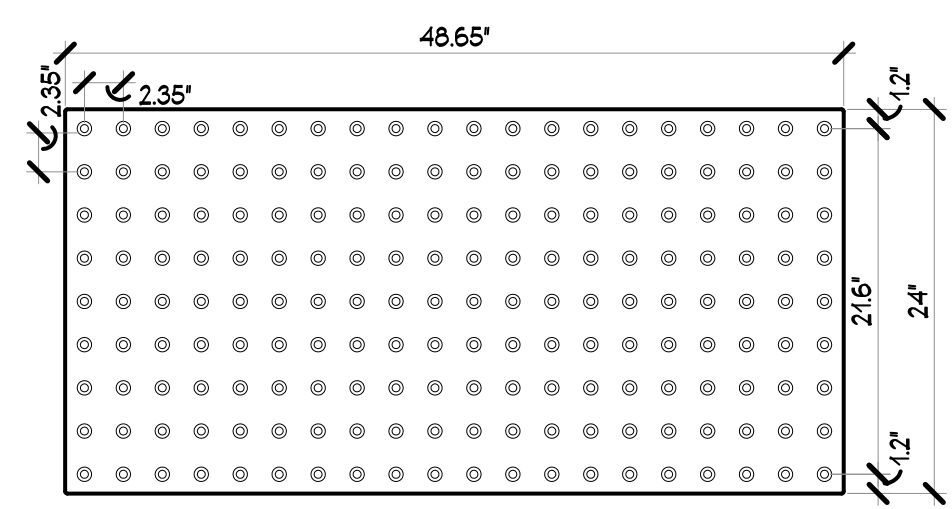

NOTE:  
1. DETECTABLE WARNING TILE SHALL BE CAST-IN-PLACE TYPE ONLY. SURFACE MOUNTING OF TILES TO EXISTING CONCRETE IS NOT ACCEPTABLE. EXISTING CONCRETE SHALL BE SAWCUT, REMOVED AND REPLACED WITH CAST-IN-PLACE.  
2. SEE PLAN FOR LOCATIONS OF DETECTABLE WARNING TILE.

**DETECTABLE WARNING**  
SCALE: 1" = 1'-0"

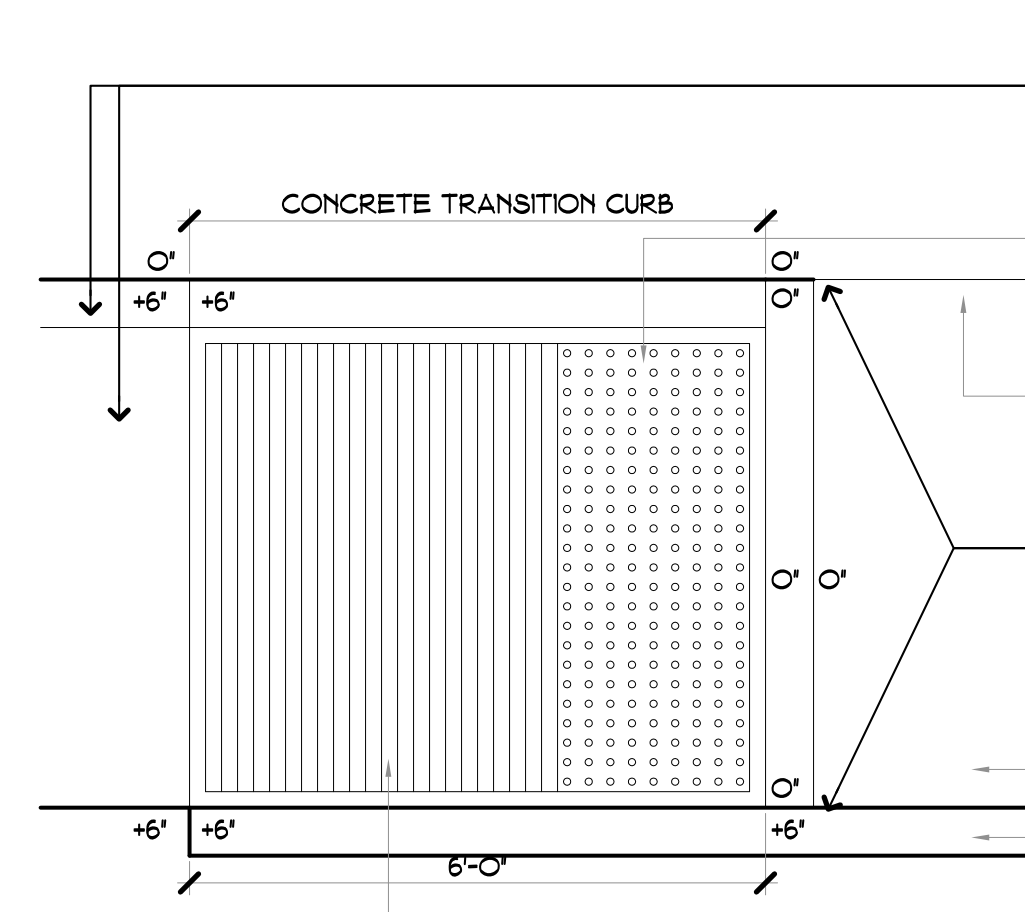

NOTE:  
ALL ACCESSIBLE CURB/RAMPS ARE 6" HT. UNLESS OTHERWISE NOTED ON PLANS. SEE PLANS FOR SPOT ELEVATIONS.

**ADA RAMP**  
SCALE: 1/2" = 1'-0"

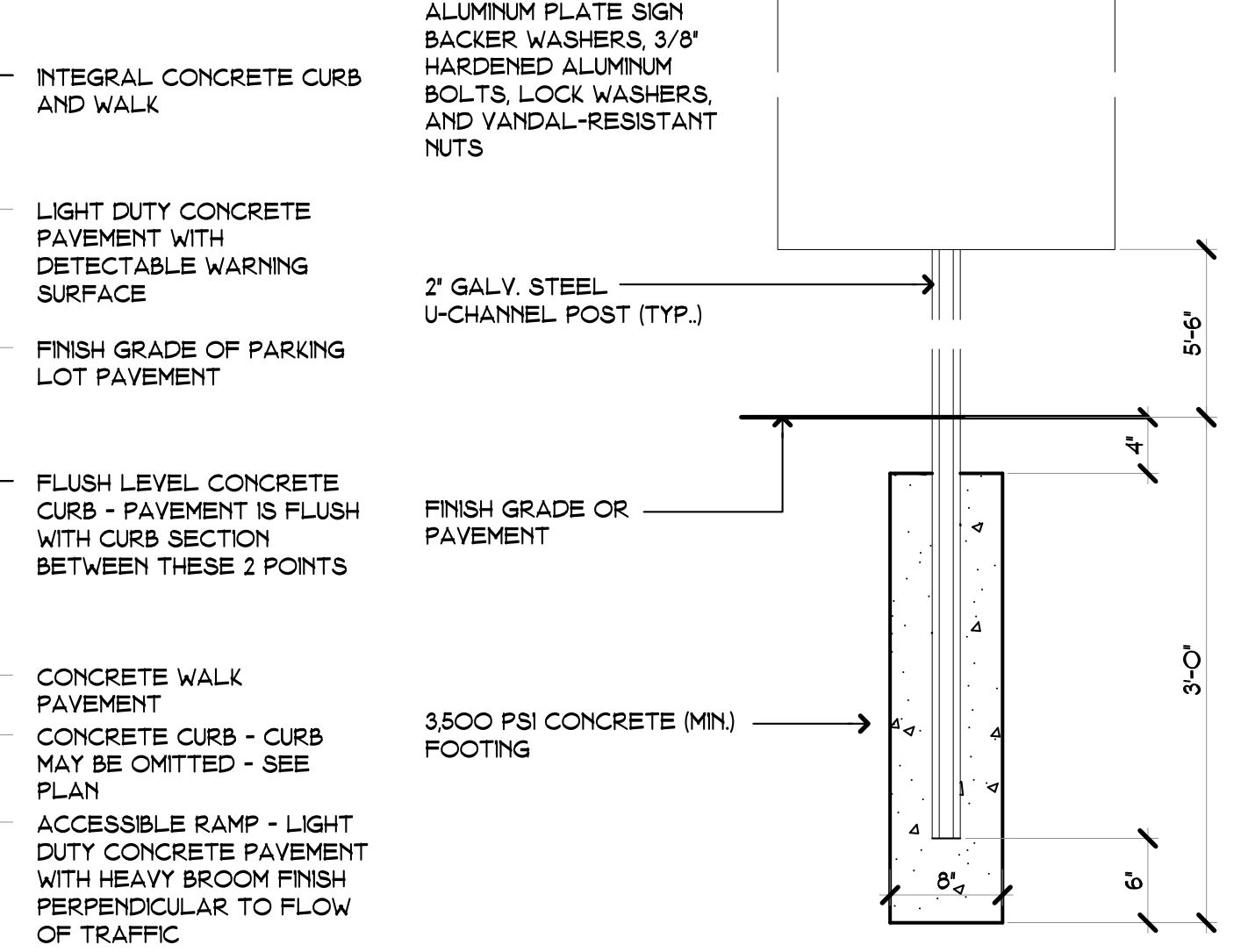

**U-CHANNEL SIGN POST**  
SCALE: 1" = 1'-0"

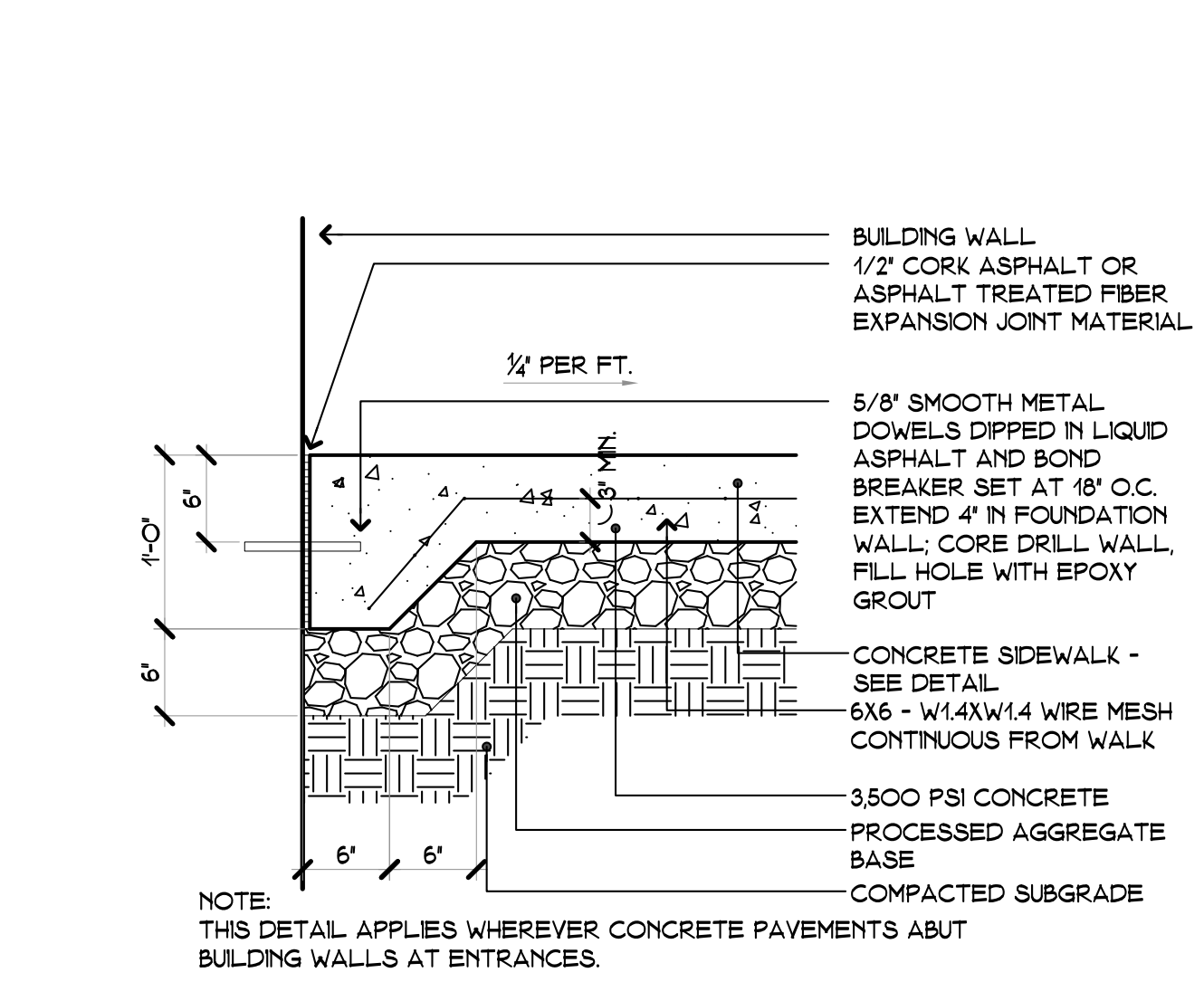

**PINNED CONCRETE SIDEWALK DET.**  
SCALE: 1" = 1'-0"

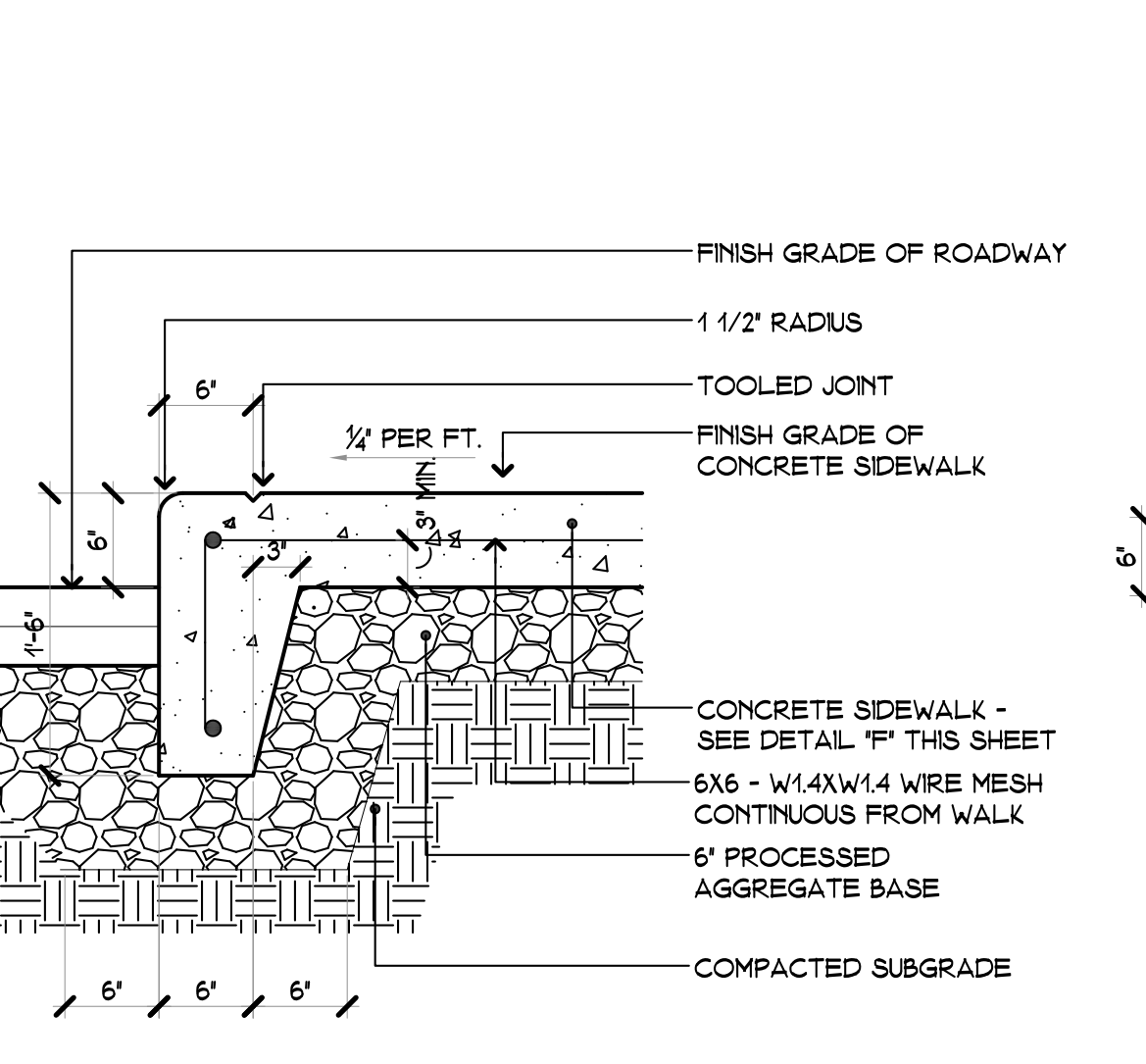

**INTEGRAL CONCRETE WALK & CURB**  
SCALE: 1" = 1'-0"

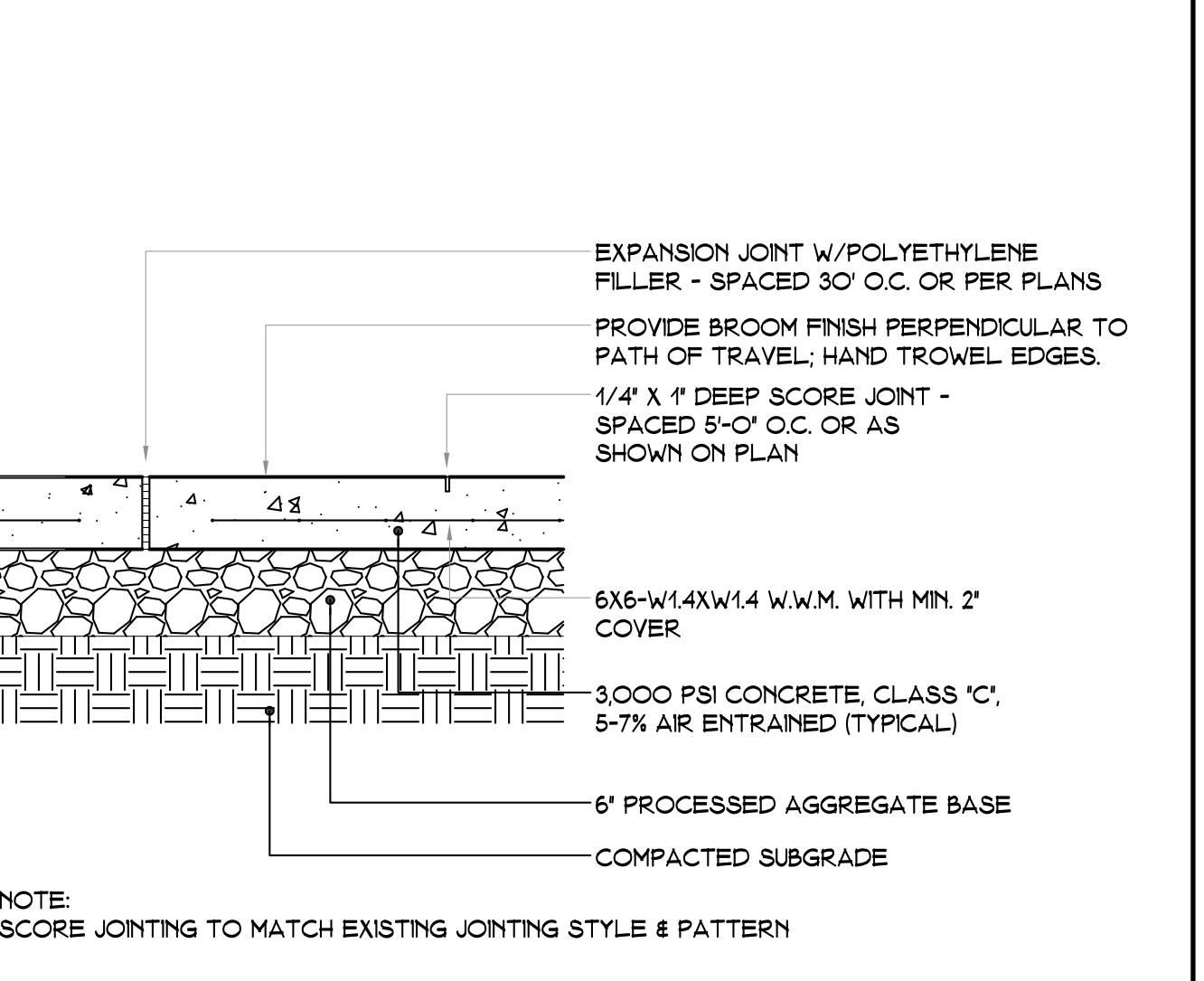

**CONCRETE WALK PAV.**  
SCALE: 1" = 1'-0"

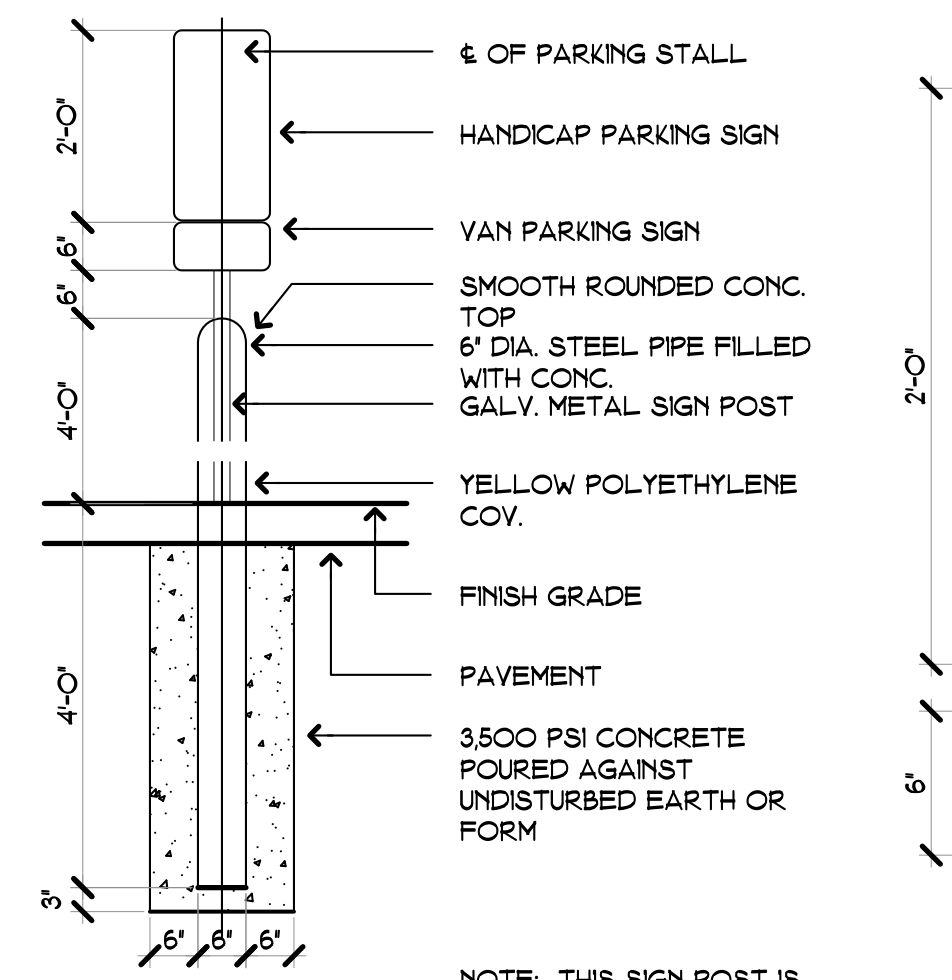

NOTE: THIS SIGN POST IS REQUIRED AT ALL ACCESSIBLE PARKING SPACES.

**ACCESSIBLE PARKING SIGN POST DETAIL**  
SCALE: 1/2" = 1'-0"

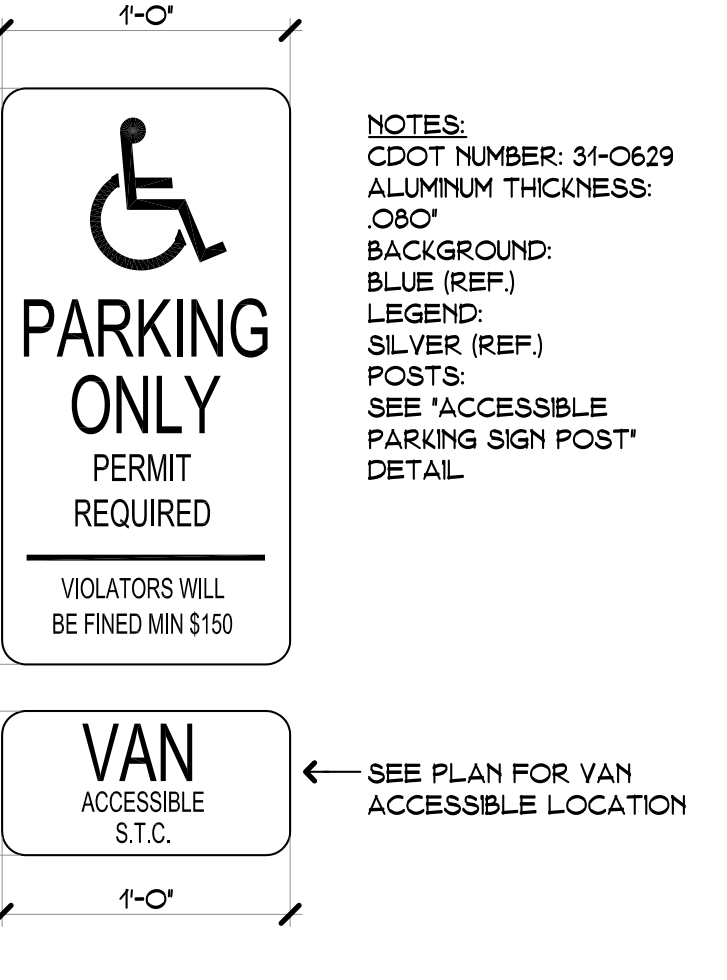

NOTE: VIOLATORS WILL BE FINED MIN \$150.

**HC PARK. SIGN**  
SCALE: 1/2" = 1'-0"

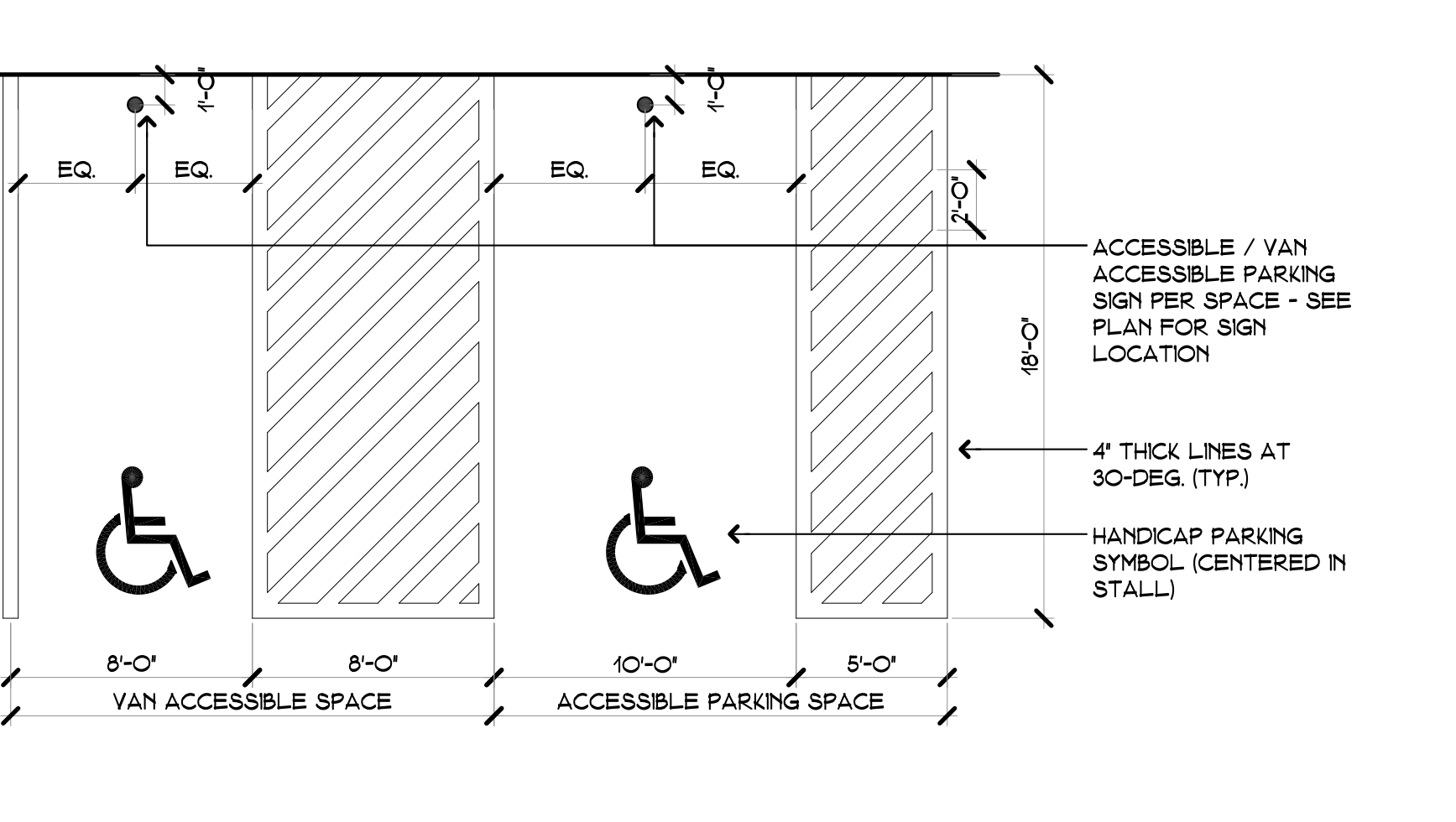

NOTE: 4" THICK LINES AT 30-DEG. (TYP.)

**TYP. ACCESSIBLE PARKING SPACE DETAIL**  
SCALE: 3/16" = 1'-0"

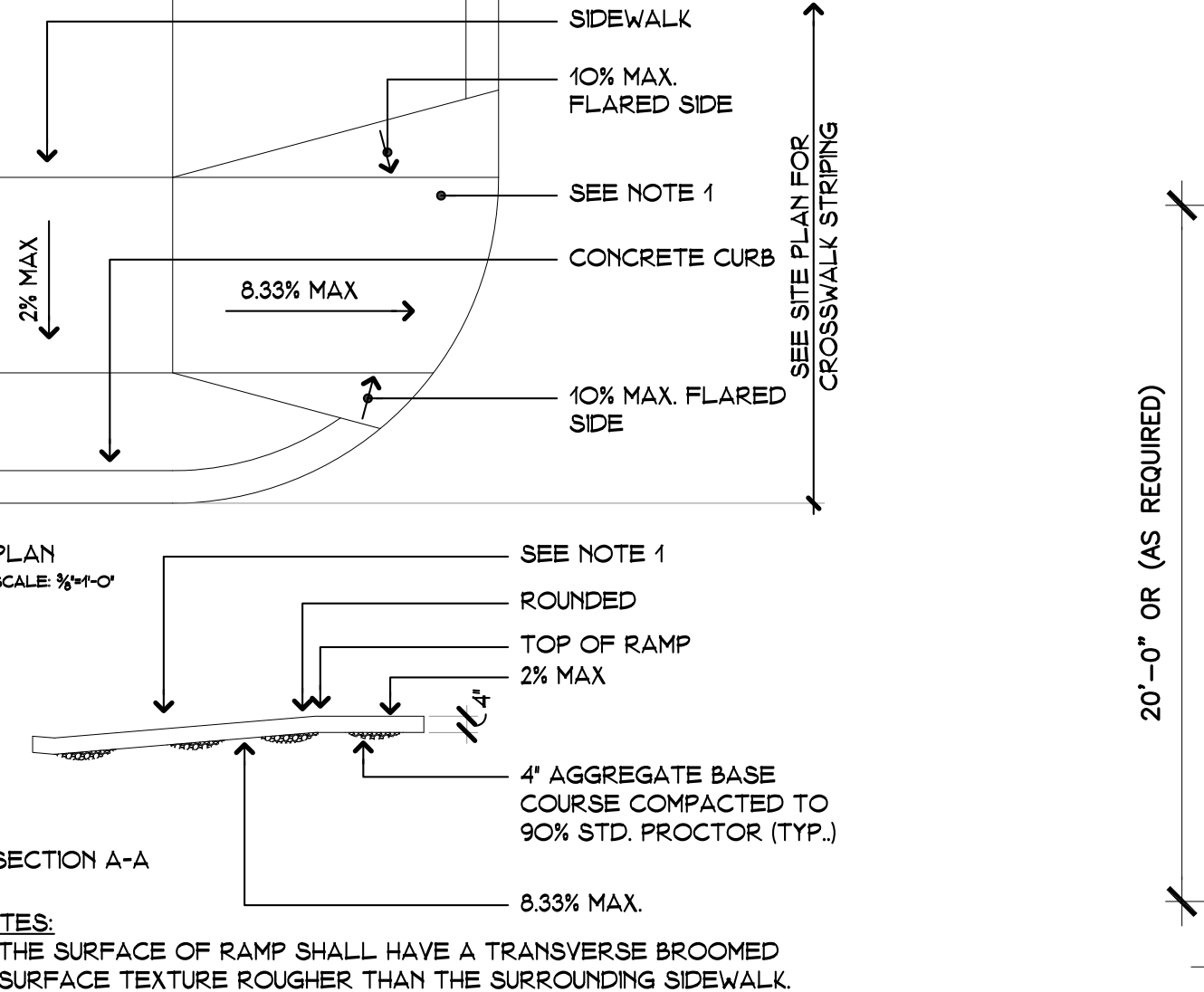

NOTE:  
1. THE SURFACE OF RAMP SHALL HAVE A TRANSVERSE BROOMED SURFACE TEXTURE ROUGHER THAN THE SURROUNDING SIDEWALK.  
2. RAMP SIDE SLOPE VARIES UNIFORMLY FROM A MAXIMUM OF UP TO 10% AT CURB TO CONFORM WITH LONGITUDINAL SIDEWALK SLOPE ADJACENT TO TOP OF THE RAMP.  
3. CONSTRUCT PER CURRENT A.D.A. STANDARDS.

**ADA RAMP IN SIDEWALK**  
SCALE: 1/8" = 1'-0"

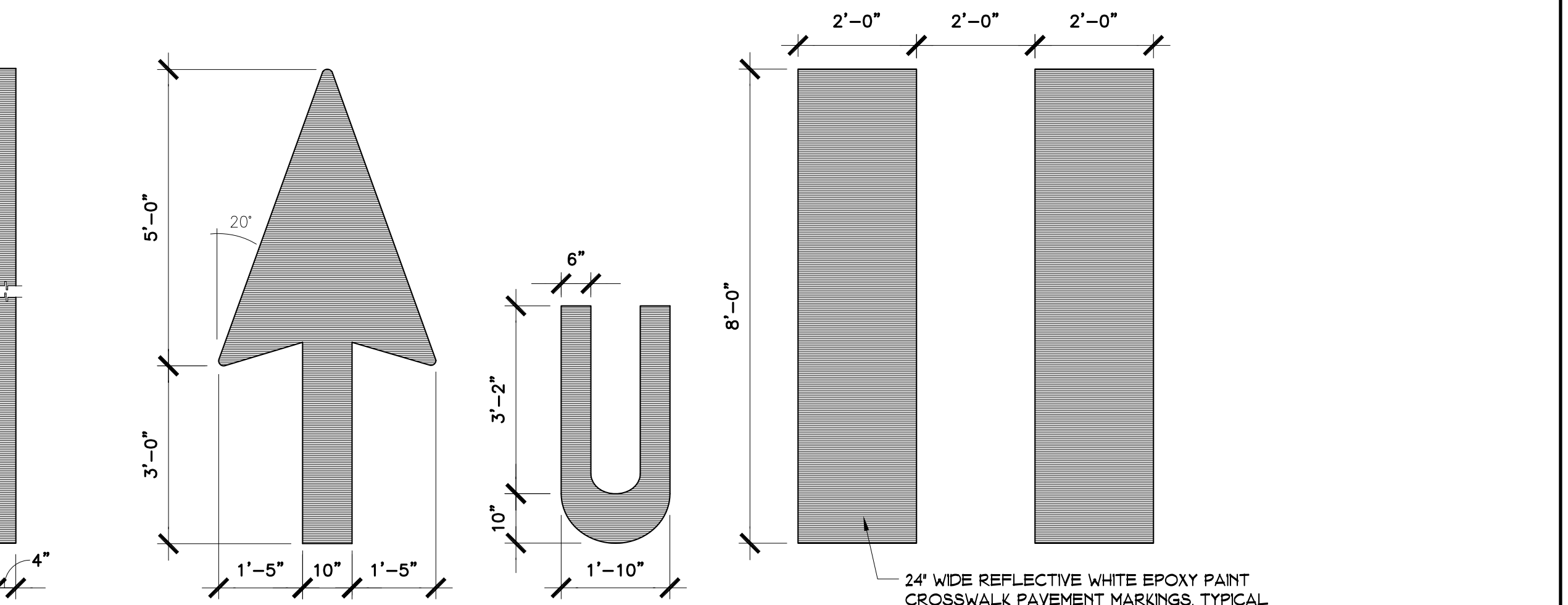

NOTE:  
1. U.O.N., USE NON-REFLECTIVE WHITE PAINT, TYP. BUT USE YELLOW PAINT ON CONCRETE OR OTHER SURFACES WHERE WHITE PAINT DOES NOT PROVIDE SUFFICIENT CONTRAST.

**TYP. PAVEMENT MARKING DETAILS**  
SCALE: 1/2" = 1'-0"

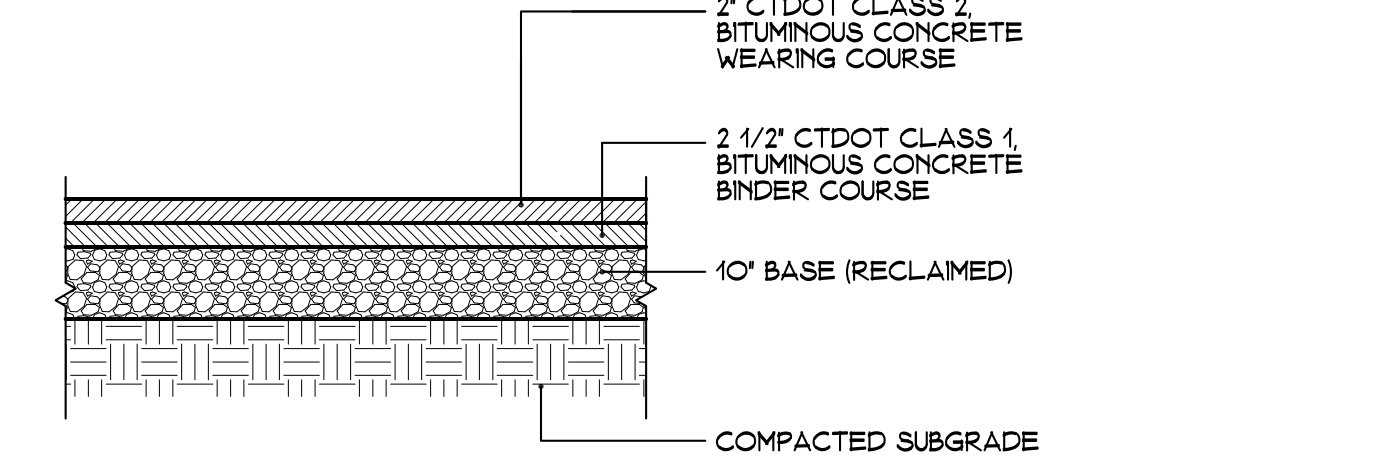

NOTE: EXISTING BITUMINOUS PAVEMENT AND BASE TO BE RECLAIMED FOR USE AS BASE MATERIAL FOR NEW BITUMINOUS PAVEMENT. EXCAVATE & ADJUST EXISTING BASE MATERIAL/SUBGRADE AS REQUIRED TO MAINTAIN EXISTING GRADES.

**BITUMINOUS PAVEMENT DETAIL (TYP)**  
SCALE: 1/2" = 1'-0"

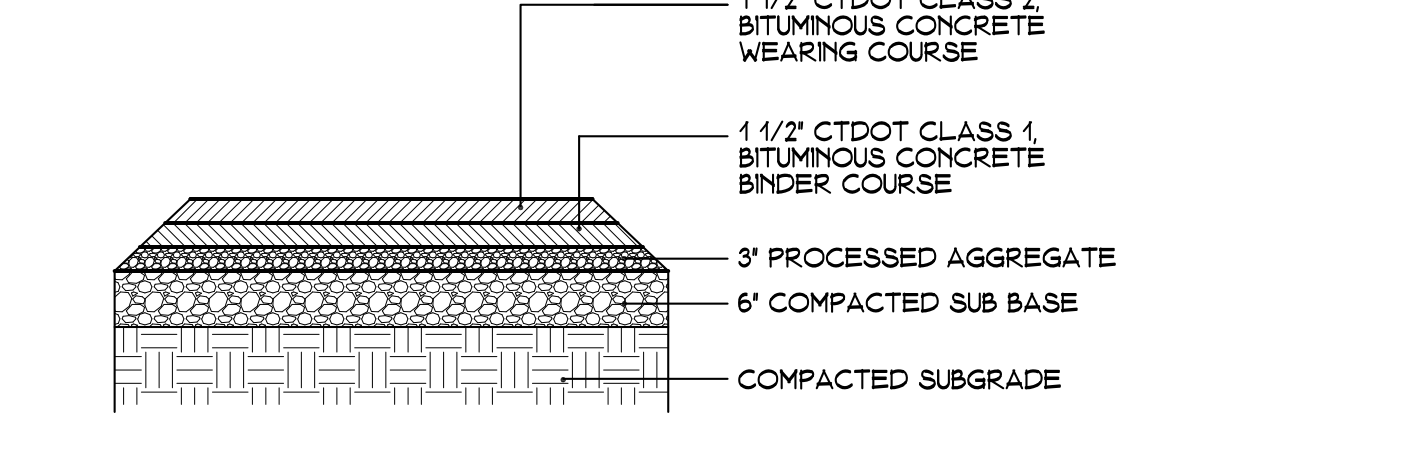

NOTE:  
1. EXISTING BITUMINOUS PAVEMENT AND BASE TO BE RECLAIMED FOR USE AS BASE MATERIAL FOR NEW BITUMINOUS PAVEMENT. EXCAVATE & ADJUST EXISTING BASE MATERIAL/SUBGRADE AS REQUIRED TO MAINTAIN EXISTING GRADES.  
2. BACKFILL 24" OUT FROM PERIMETER OF SIDEWALK W/TOPSOL AND SEED.

**BITUMINOUS SIDEWALK DETAIL (TYP)**  
SCALE: 1/2" = 1'-0"

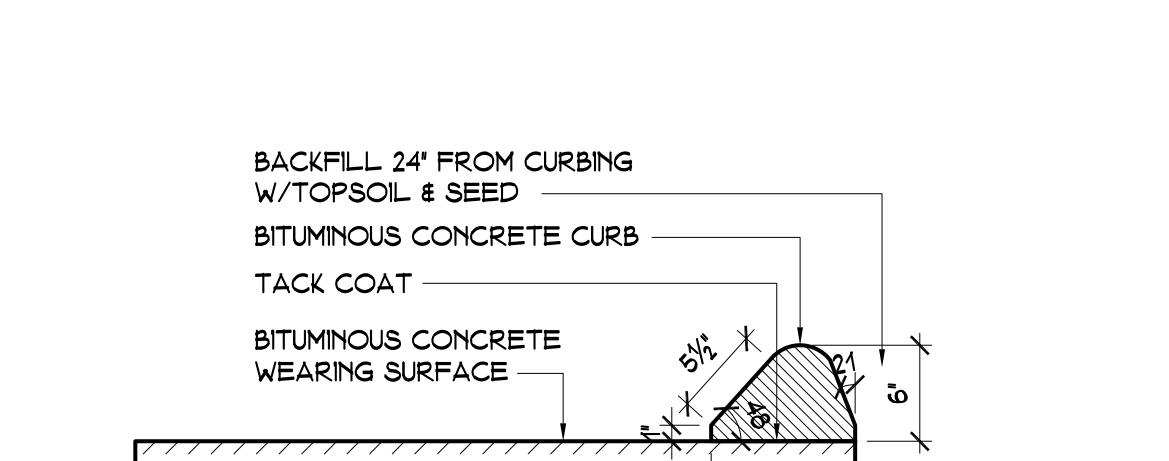

NOTE: BACKFILL 24" FROM CURBING W/TOPSOL & SEED.

**TYPICAL BITUMINOUS CURB DETAIL**  
SCALE: 1" = 1'-0"

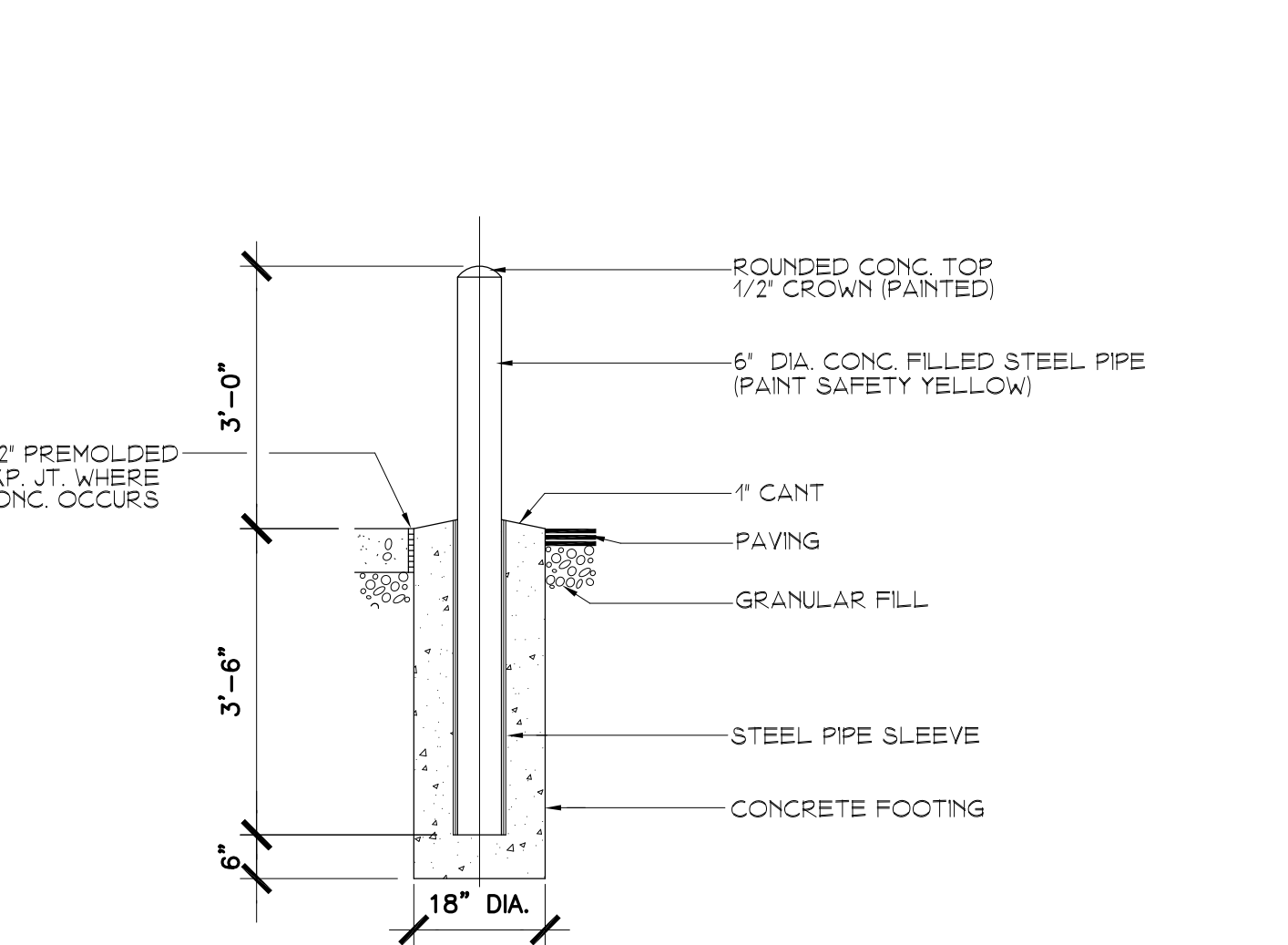

**TYPICAL PIPE BOLLARD DETAIL**  
SCALE: 1/2" = 1'-0"

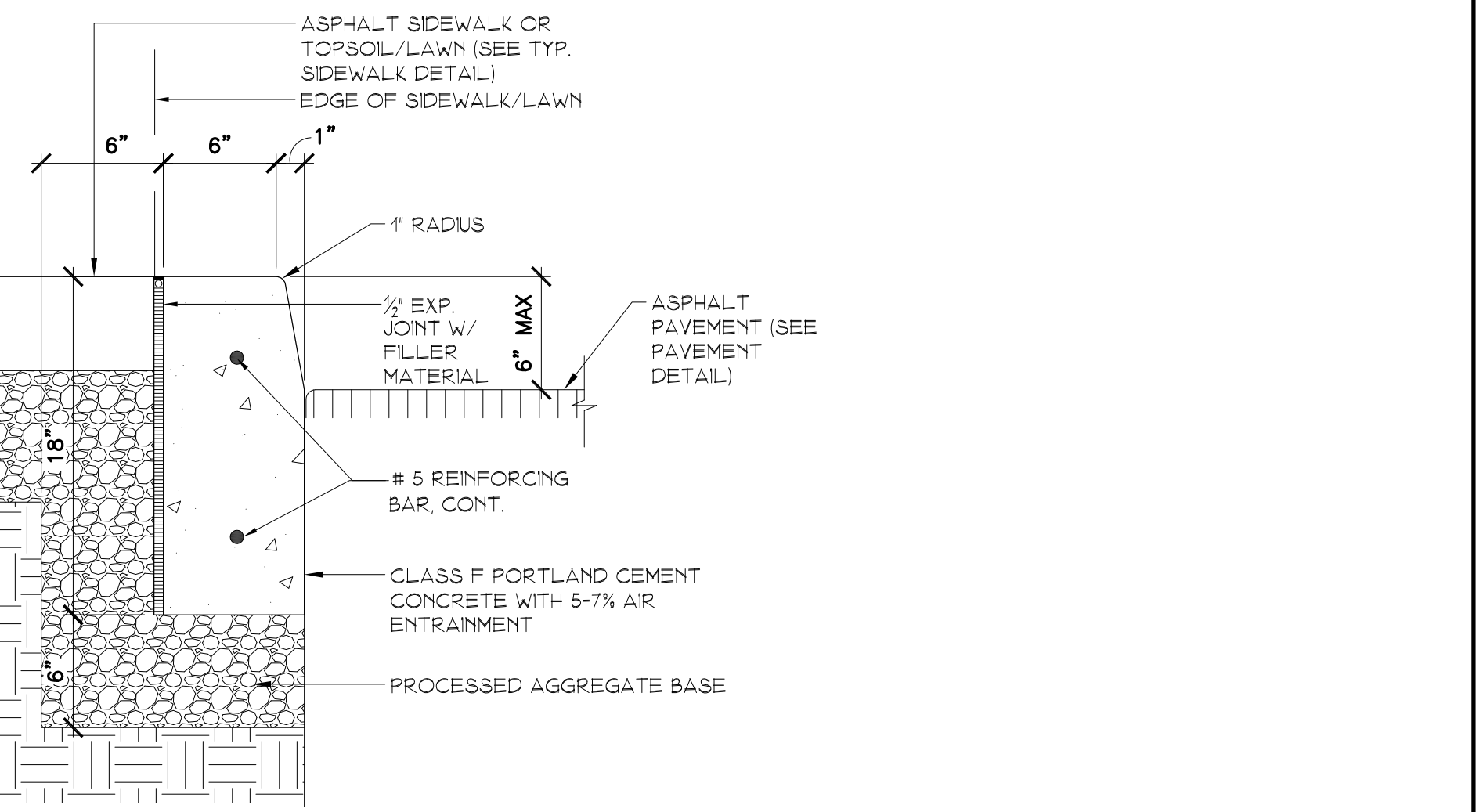

**TYPICAL CAST-IN-PLACE CONCRETE CURB DETAIL**  
SCALE: 1-1/2" = 1'-0"

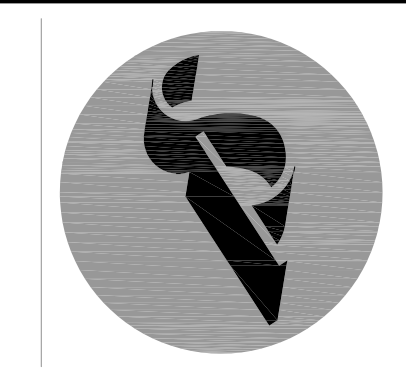

Revision	Description	Date	Revised By